

Compatible models for ORP60-E replacement probe:

- **ORP60, PH60, PH60S, PH60F**

**How to replace the probe?**

Screw off the probe ring, unplug the probe, plug in the new replacement probe (pay attention to the probe's position), and screw on the probe ring.

Go to [www.aperainst.de](http://www.aperainst.de) to watch some tutorial videos.

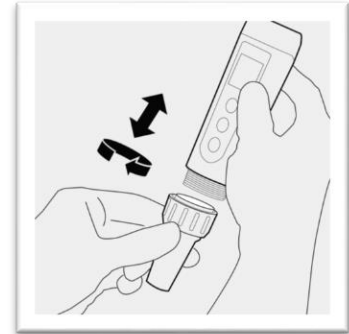

We warrant this electrode to be free from defects in material and workmanship and agree to repair or replace free of charge, at option of APERA INSTRUMENTS (Europe) GmbH any malfunctioned or damaged product attributable to responsibility of APERA INSTRUMENTS (Europe) GmbH for a period of **six-month**. This warranty does not apply to defects resulting from actions such as misuse (violation of the instructions in this manual or operations in the manner not specified in this manual), improper maintenance, or unauthorized repairs. Warranty period is the time limit to provide free service for the products purchased by customers, not the service life of the probe.

APERA INSTRUMENTS (Europe) GmbH  
Wilhelm-Muthmann-Straße 15  
42329 Wuppertal, Germany  
Tel. +49 202 51988998  
info@aperainst.de  
www.aperainst.de